

NOTES:

1. MATERIAL:SEE BOM
2. FINISH: N/A
3. PART IS TO BE CLEAN AND FREE OF GREASE, DIRT, OIL, AND ALL OTHER CONTAMINANTS.
4. DRAWING SHOWN WITH OPTIONAL MOUNTING FEET AND HARDWARE.

BATTERIES SHOWN FOR REFERENCE ONLY. SOLD SEPARATELY

REVISIONS			
REV.	DESCRIPTION	DATE	APPROVED
A	INITIAL RELEASE	7/21/2009	RNA

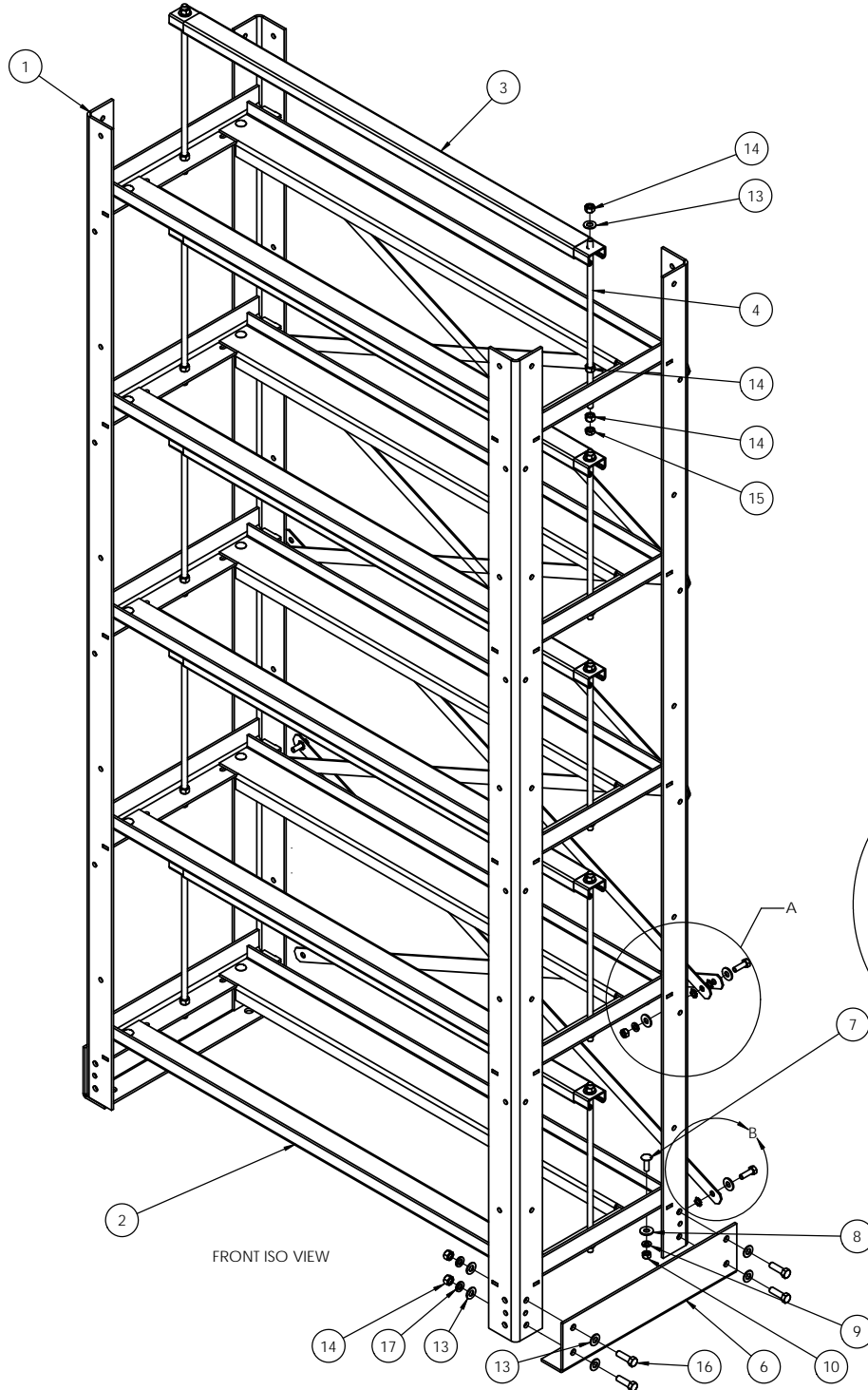

FRONT ISO VIEW

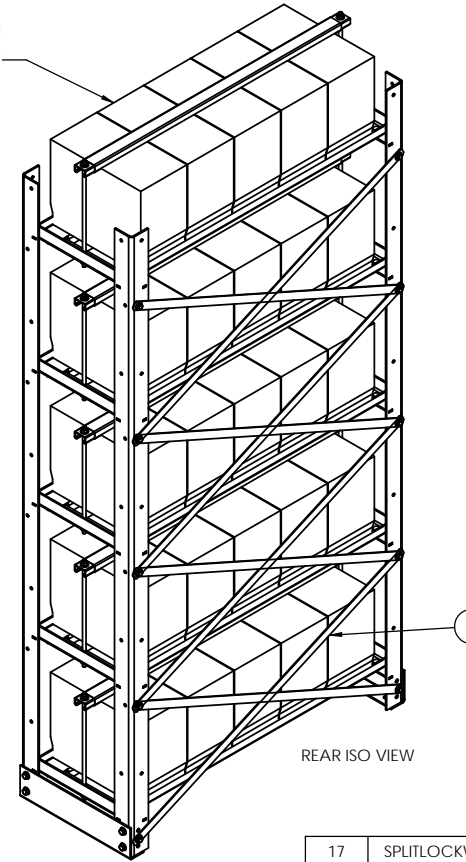

REAR ISO VIEW

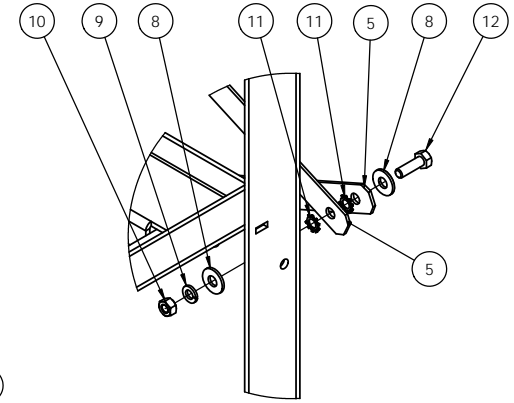

DETAIL A  
SCALE 1 : 3

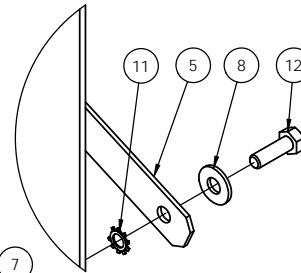

DETAIL B  
SCALE 1 : 2

17	SPLITLOCKWASHER3/8ZINC	3/8" LOCK WASHER, Z.P.	8
16	HEXBOLT3/8-16X1-1/4ZINC	HBOLT 0.3750-16x1-1/4", Z.P.	8
15	HEXJAMNUT3/8-16ZINC	HEX JAM NUT, 3/8-16, ZINC	10
14	HEXNUT3/8-16ZINC	HEX NUT, 3/8-16, ZINC	38
13	FLATWASHER3/8ZINC	3/8" FLAT WASHER, Z.P.	26
12	HEXBOLTS5/16-18X1ZINC	HEX BOLT, 5/16-18 X 1.0, ZINC	10
11	EXTTOOTHWASHER.312ZINC	EXTERNAL TOOTH WASHER, 5/16, ZINC	6
10	HEXNUTS5/16-18ZINC	NUT, HEX, 5/16-18 ZINC	30
9	SPLITLOCKWASHERS5/16ZINC	WASHER, SPLIT LOCK, 5/16 ZC	30
8	FLATWASHER3/8ZINC	WASHER, FLAT, .312, ZC	40
7	CARRIAGEBOLT5/16-18X1ZINC	CARRIAGE BOLT, 5/16-18 X 1.0, ZC	20
6	BRC-000900	FEET, BRACE, OPEN FRAME RACKS	2
5	BRC-000800	BRACE, BATTERY RACK, 5 WIDE	8
4	BRC-000500	BRACE, BATT. HOLD DOWNS	10
3	RST-000703	HOLD DOWN, BATT., 5-WD,WITH SHRINK	5
2	BTR-000203	BATTERY RAILS, 5 WIDE	10
1	FRM-006600	FRAME,5 TIER	2
ITEM NO.	PART NUMBER	DESCRIPTION	Default/ QTY

UNLESS OTHERWISE SPECIFIED:

DIMENSIONS ARE IN INCHES  
TOLERANCES:

ANGULAR: MACH ± .5 BEND ±1  
TWO PLACE DECIMAL ± .01  
THREE PLACE DECIMAL ± .005

PROJECTION:

MATERIAL:

SEE NOTE 1

FINISH:

SEE NOTE 2

DO NOT SCALE DRAWING

**ELECTRONIC SYSTEM SUPPORT**  
888-475-9292 www.ess.to

110 AUSTIN STREET  
GARLAND, TX 75040  
PH. 972-272-2468  
FAX 972-276-9844

DATE	NAME	TITLE
07-24-09	RNA	BATTERY RACK, 5 TIER/5 WIDE OPEN FRAME
DRAWN	CHECKED	SIZE DWG. NO. REV
ENG APPR	MFG APPR	C R5T5 A
QA		SCALE: 1:8 WEIGHT: SHEET 1 OF 2

PROPRIETARY AND CONFIDENTIAL  
THE INFORMATION CONTAINED IN THIS  
DRAWING IS THE SOLE PROPERTY OF  
ELECTRONIC SYSTEMS SUPPORT. ANY  
REPRODUCTION IN PART OR AS A WHOLE  
WITHOUT THE WRITTEN PERMISSION OF  
ELECTRONIC SYSTEMS SUPPORT IS  
PROHIBITED.

USED ON

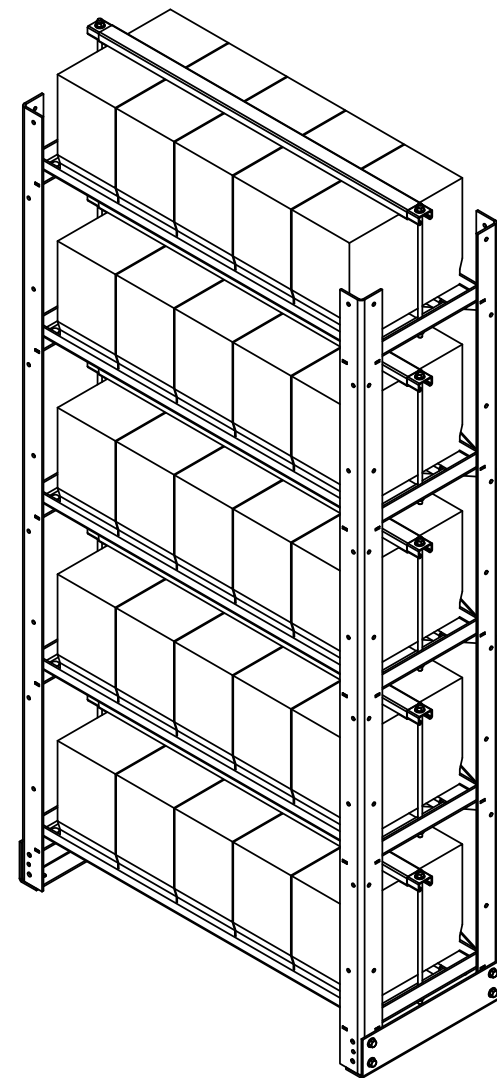
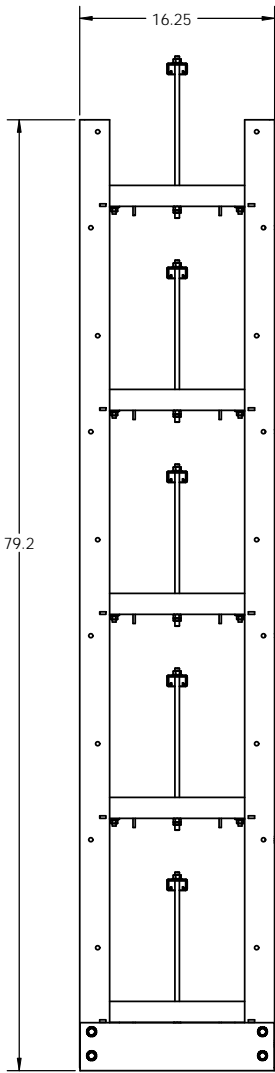
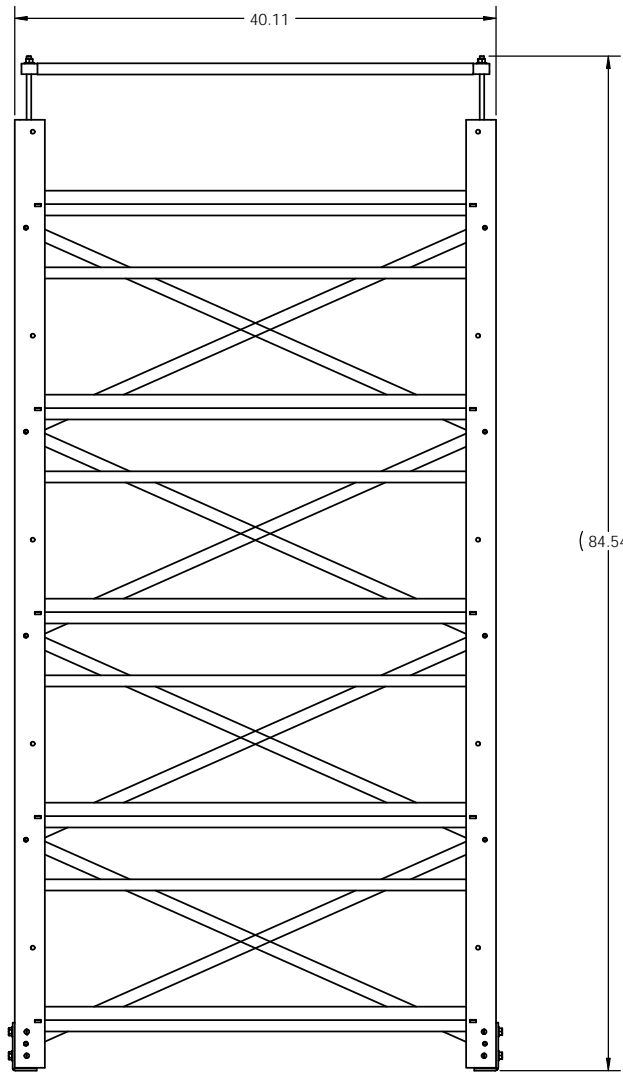

PROPRIETARY AND CONFIDENTIAL  
 THE INFORMATION CONTAINED IN THIS  
 DRAWING IS THE SOLE PROPERTY OF  
 ELECTRONIC SYSTEMS SUPPORT. ANY  
 REPRODUCTION IN PART OR AS A WHOLE  
 WITHOUT THE WRITTEN PERMISSION OF  
 ELECTRONIC SYSTEMS SUPPORT IS  
 PROHIBITED.

UNLESS OTHERWISE SPECIFIED:		<b>ELECTRONIC SYSTEM SUPPORT</b> 888-475-9292 www.ess.to		110 AUSTIN STREET GARLAND, TX 75040 PH. 972-272-2468 FAX 972-276-9844	
DIMENSIONS ARE IN INCHES		DRAWN	NAME	DATE	TITLE
TOLERANCES:		CHECKED	RNA	07-24-09	BATTERY RACK, 5 TIER/5 WIDE OPEN FRAME
ANGULAR: MACH ± .5 BEND ± 1		ENG APPR			SIZE
TWO PLACE DECIMAL ± .01		MFG APPR			DWG. NO.
THREE PLACE DECIMAL ± .005		Q.A.			REV
PROJECTION:		SEE NOTE 1		C	
MATERIAL:		SEE NOTE 2		R5T5	
FINISH:		DO NOT SCALE DRAWING		A	
USED ON		SCALE: 1:8		WEIGHT: SHEET 2 OF 2	