

NOTES:

1. MATERIAL: HEAVY GAUGE WELDED STEEL
2. FINISH: POWDER COAT ASA 61 GRAY
3. APPROXIMATE UNPACKAGED RACK WEIGHT: 60 LBS.
4. FRAME CONSTRUCTION, BATTERY SUPPORT RAIL DESIGN, AND SEISMIC BRACKET OPTIONS ARE SEISMIC CERTIFIED TO UBC (UNIFORM BUILDING CODE) SECTION 1632.

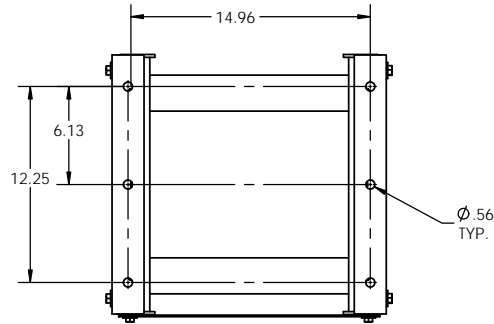
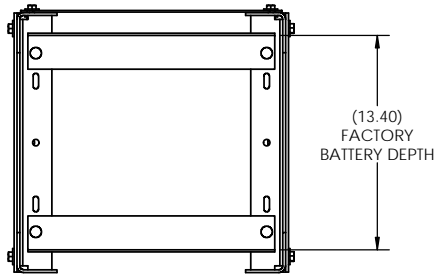

SECTION A-A  
BOTTOM VIEW  
OPTIONAL SEISMIC MOUNTING FOOTPRINT

BATTERIES SHOWN FOR  
REFERENCE ONLY.  
SOLD SEPARATELY

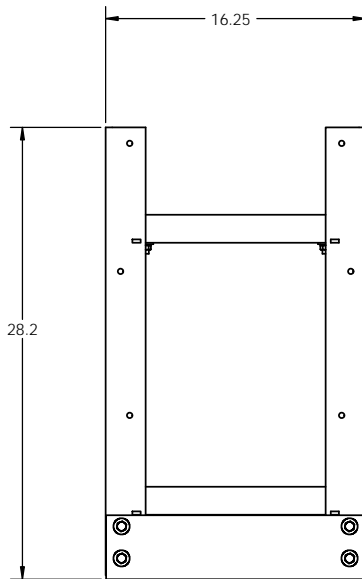
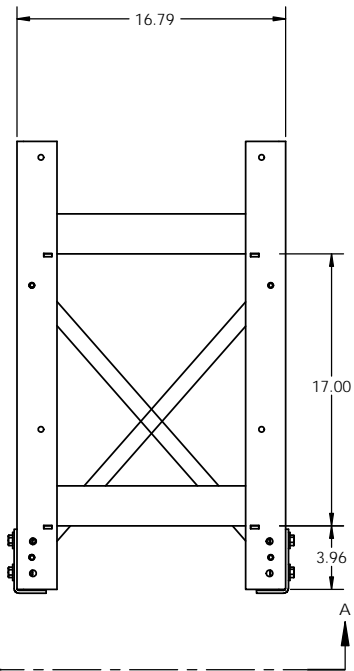
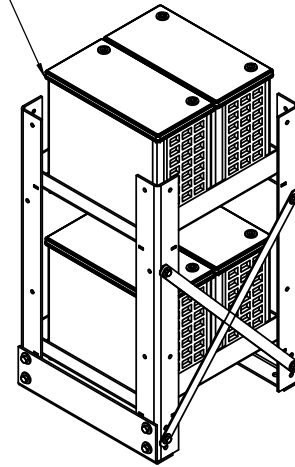

MAX BATTERY CAPACITY	
BATTERY TYPE	QTY
100 wpc	6
250 wpc - 800 wpc	4

**PROPRIETARY AND CONFIDENTIAL**  
THE INFORMATION CONTAINED IN THIS DRAWING IS THE SOLE PROPERTY OF ELECTRONIC SYSTEMS SUPPORT. ANY REPRODUCTION IN PART OR AS A WHOLE WITHOUT THE WRITTEN PERMISSION OF ELECTRONIC SYSTEMS SUPPORT IS PROHIBITED.

UNLESS OTHERWISE SPECIFIED: DIMENSIONS ARE IN INCHES		 <b>Electronic Systems Support</b> www.ess.to		3233 W. Kingsley Rd. Garland, Texas 75041 PH. 972-272-2468 FAX 972-276-9844	
TITLE: <b>BATTERY RACK, VRLA, 2 TIER/2 WIDE, SEISMIC Z4</b>					
PROJECTION: 	NAME: RNA	DATE: 07-20-09	SIZE: <b>C</b>	DWG. NO.: <b>R2T2Z4-SPEC</b>	REV: <b>B</b>
SCALE: 1:8				SHEET 1 OF 1	