

NOTES:

1. MATERIAL: HEAVY GAUGE WELDED STEEL
2. FINISH: TELCO GRAY POWDER COAT  
(OTHER COLORS AVAILABLE, SEE PART NUMBER LEGEND)
3. IT IS RECOMMENDED TO SUPPORT RACKS TALLER THAN 8 FT. FROM TOP IN ADDITION TO FLOOR MOUNTING.
4. APPROXIMATE UNPACKAGED WEIGHT: 61 LBS (84" TALL RACK)

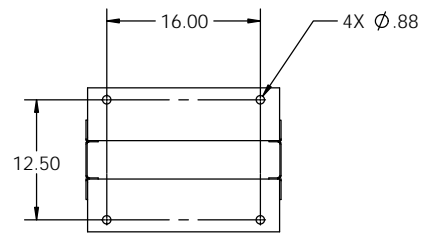

SECTION C-C  
SCALE 1 : 10

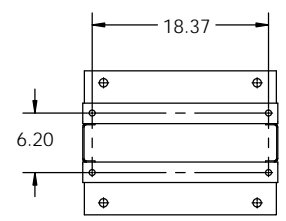
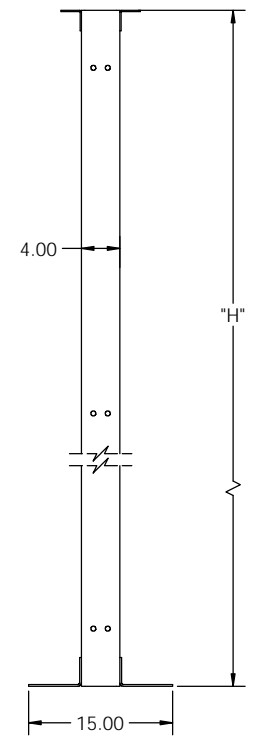
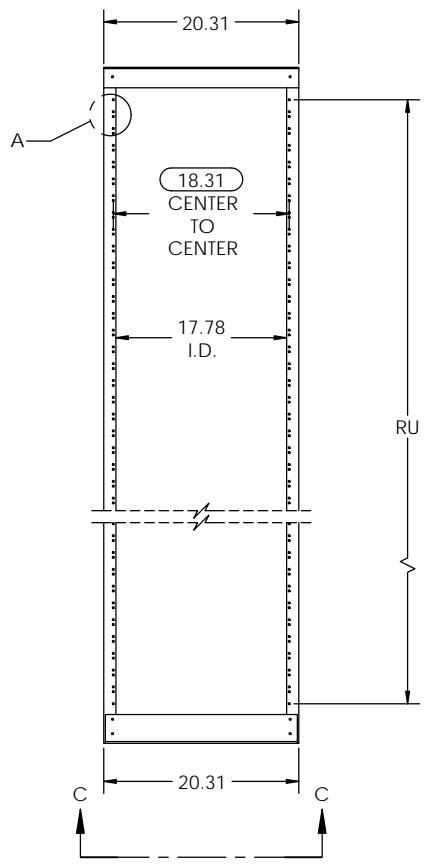

**EQUIPMENT RACK PART NUMBER LEGEND**

EQR 2 A 084 A A

RACK COLOR	
A	TELCO GRAY
B	BLACK
C	BLUE
D	WHITE
E	CREAM
F	KONE GRAY

HOLE SPACING	
A	EIA

RACK HEIGHT		
	H	RU(EIA)
060	5'	30
066	5'6"	34
072	6'	37
078	6'6"	41
084	7'	44
090	7'6"	47
096	8'	51
108	9'	58
138	11'6"	75

RACK WIDTH	
A	19" PANEL MOUNTING

RACK STYLE	
2	STANDARD

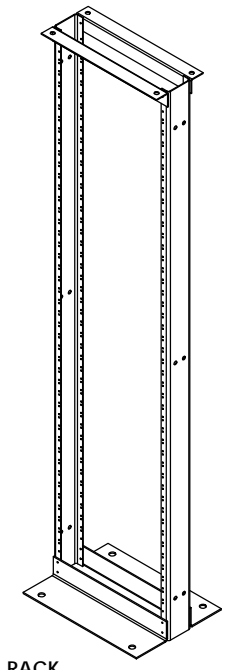
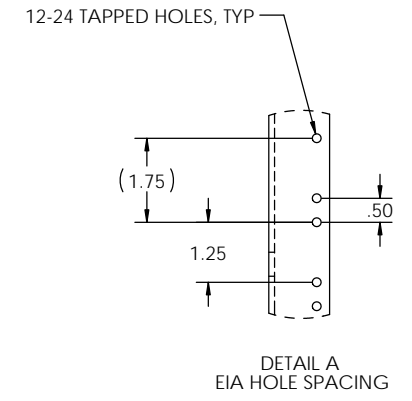

**EIA RACK**

PROPRIETARY AND CONFIDENTIAL  
THE INFORMATION CONTAINED IN THIS DRAWING IS THE SOLE PROPERTY OF ELECTRONIC SYSTEMS SUPPORT. ANY REPRODUCTION IN PART OR AS A WHOLE WITHOUT THE WRITTEN PERMISSION OF ELECTRONIC SYSTEMS SUPPORT IS PROHIBITED.

UNLESS OTHERWISE SPECIFIED: DIMENSIONS ARE IN INCHES		<b>Electronic Systems Support</b> www.ess.to		3233 W. Kingsley Rd. Garland, Texas 75041 PH. 972-272-2468 FAX 972-276-9844	
TITLE: EQ. RACK, 19" PANEL MNTG., 4" CHANNEL, LIGHT DUTY					
PROJECTION:	NAME: RNA	DATE: 03-07-17	SIZE: <b>C</b>	DWG. NO.: EQR2Axxxxx-SPEC	REV: B
SCALE: 1:24				SHEET 1 OF 2	

NOTES:

1. MATERIAL: HEAVY GAUGE WELDED STEEL
2. FINISH: TELCO GRAY POWDER COAT  
(OTHER COLORS AVAILABLE, SEE PART NUMBER LEGEND)
3. IT IS RECOMMENDED TO SUPPORT RACKS TALLER THAN 8 FT. FROM TOP IN ADDITION TO FLOOR MOUNTING.
4. APPROXIMATE UNPACKAGED WEIGHT: 61 LBS (84" TALL RACK)

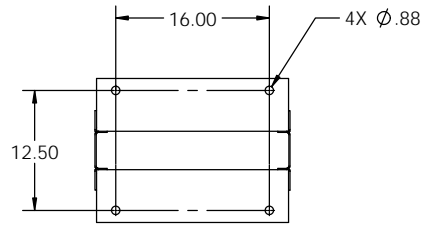
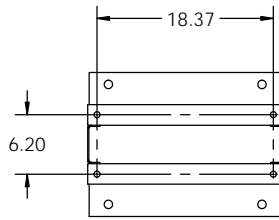

SECTION B-B  
SCALE 1 : 10

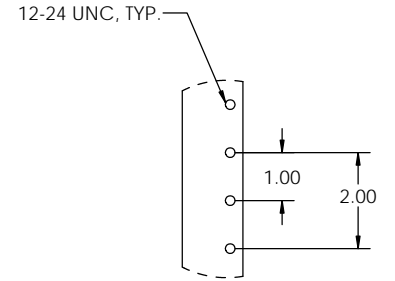
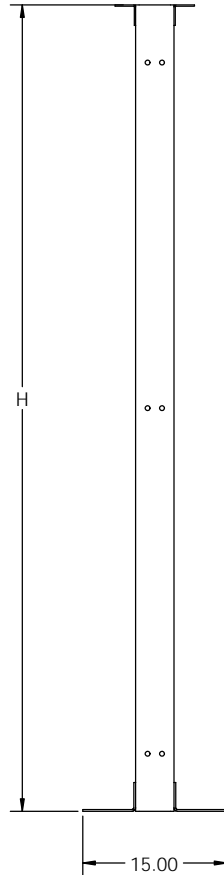
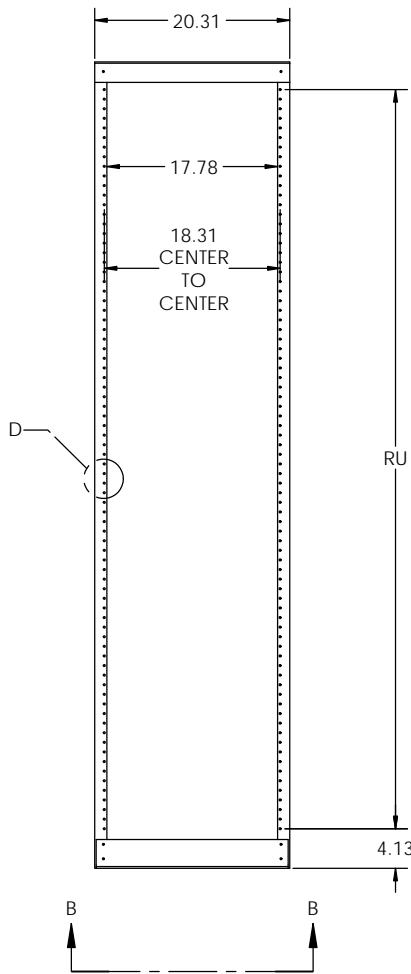

DETAIL D  
SCALE 1 : 2  
WECCO HOLE SPACING

**EQUIPMENT RACK PART NUMBER LEGEND**

EOR 2 A 084 B A

RACK COLOR	
A	TELCO GRAY
B	BLACK
C	BLUE
D	WHITE
E	CREAM
F	KONE GRAY

HOLE SPACING	
B	WECCO

RACK HEIGHT		
	H	RU(WECCO)
060	5'	27
066	5'6"	30
072	6'	33
078	6'6"	36
084	7'	39
090	7'6"	42
096	8'	45
108	9'	51
138	11'6"	66

RACK WIDTH	
A	19" PANEL MOUNTING

RACK STYLE	
2	STANDARD

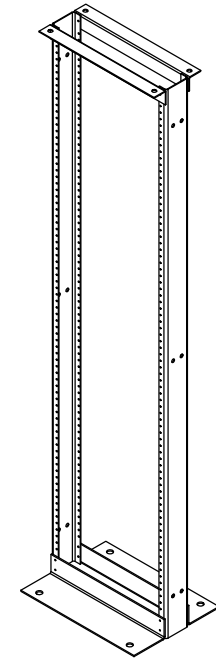

**WECO RACK**

PROPRIETARY AND CONFIDENTIAL  
THE INFORMATION CONTAINED IN THIS DRAWING IS THE SOLE PROPERTY OF ELECTRONIC SYSTEMS SUPPORT. ANY REPRODUCTION IN PART OR AS A WHOLE WITHOUT THE WRITTEN PERMISSION OF ELECTRONIC SYSTEMS SUPPORT IS PROHIBITED.

UNLESS OTHERWISE SPECIFIED: DIMENSIONS ARE IN INCHES		<b>Electronic Systems Support</b> 3233 W. Kingsley Rd. Garland, Texas 75041 PH. 972-272-2468 FAX 972-276-9844 www.ess.to	
TITLE: EQ. RACK, 19" PANEL MNTG., 4" CHANNEL, LIGHT DUTY			
PROJECTION:	NAME: RNA	DATE: 03-07-17	REV: B
SIZE: C	DWG. NO.: EQR2Axxxx-SPEC		SHEET 2 OF 2
SCALE: 1:24			